

Grooved End Connection

Series F Aluminum Bronze

- Lever Operated Ball Valve
- 2000 PSI WP
- 2"
- Bolted Body Construction
 - Enhanced Protection Against CO₂ and Saltwater Corrosion
 - Multi-Seal Seats
 - Fire Safe Design
 - NACE Standard
 - Rugged Locking Device Standard
 - Maintenance Free

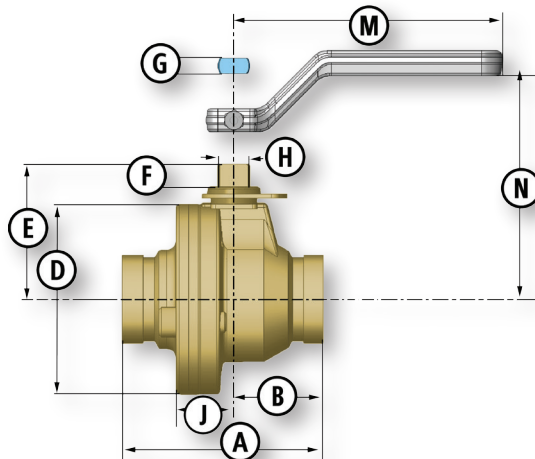
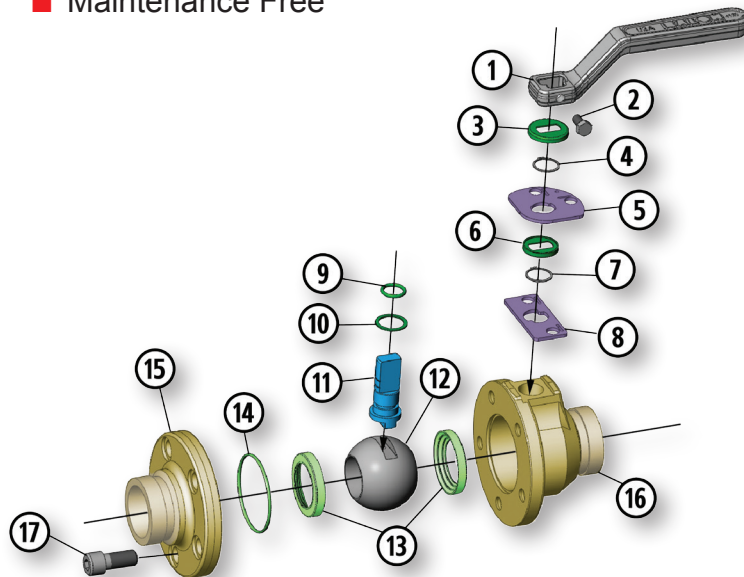
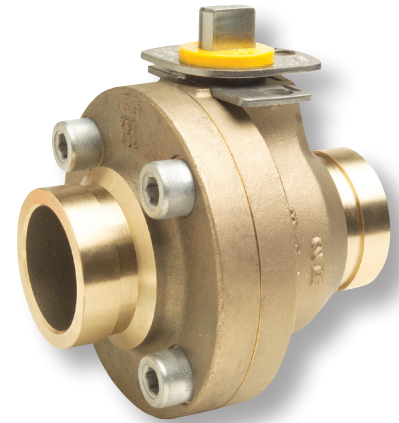

Material Description

| ITEM | PART NAME | MATERIAL NACE (STANDARD) |
|------|---------------------|--------------------------|
| 1 | Handle* | Carbon Steel |
| 2 | Handle Bolt | Standard Hex Bolt |
| 3 | Weather Guard | Polyethylene |
| 4 | Lock Plate Retainer | Stainless Steel |
| 5 | Lock Plate | Stainless Steel |
| 6 | Dust Cover | Polyethylene |
| 7 | Stop Plate Retainer | Stainless Steel |
| 8 | Stop Plate | Stainless Steel |
| 9 | Stem O-Ring | Fluorocarbon |
| 10 | Stem Seal | TFE |
| 11 | Stem | 316 Stainless Steel |
| 12 | Ball | 316 Stainless Steel |
| 13 | Ball Seat | Nylon (TFE Optional) |
| 14 | Body O-Ring | Fluorocarbon |
| 15 | End Adapter | ASTM B148-9D (955) |
| 16 | Body | ASTM B148-9D (955) |
| 17 | Body Bolts | ASTM A193 B7M |

*Handle is optional. Balon valves can also be operated with a standard open-end wrench.

Dimensional Data

| SIZE | CATALOG | PORT | A | B | D | E | F | G | H | J | M | N | LBS. | HANDLE | Cv |
|---------|------------|------|-----|------|------|------|-----|------|------|------|------|------|------|-----------|-----|
| 2x1.5x2 | 2R-F94N-GE | 1.5 | 5.5 | 2.75 | 4.87 | 3.62 | .75 | .497 | .873 | 1.62 | 7.25 | 5.25 | 11.5 | P-4128-CS | 140 |